

LOWER CONCOURSE: ROOM DIMENSIONS AND SEATING CAPACITY

Rm	Name	Dimensions	Area *	Height	Theatre	Class Room	Square	U-Shape	Reception	Banquet
1	GRAND BALLROOM	103'2" x 186'3"	20,212 ft ²	19'10"	2,300	1,400	-	-	3,500	1,900
2	GRAND WEST	103'2" x 52'5"	6,466 ft ²	19'10"	450	228	-	-	700	450
3	GRAND CENTRE	103'2" x 54'1"	5,546 ft ²	19'10"	650	300	-	-	700	450
4	GRAND EAST	103'2" x 52'7"	5,390 ft ²	19'10"	624	300	-	-	700	450
5	GRAND EAST (LARGE)	103'2" x 79'8"	8,169 ft ²	19'10"	900	530	-	-	1,000	700
6	GRAND BALLROOM FOYER	157' x 67'1"	6,476 ft ²	11'10"	-	-	-	-	2,000	-
7	VIDE OFFICE	-	475 ft ²	-	-	-	Note: Two Window Registration Potential			
8	VIDE	68'7" x 74'8"	4,456 ft ²	14'11"	-	-	-	-	-	-
9	SHERATON HALL A	25'6" x 56'7"	1,369 ft ²	14'4"	120	75	48	42	180	100
10	SHERATON HALL B	26'2" x 56'7"	1,479 ft ²	14'4"	120	75	48	42	180	100
11	SHERATON HALL C	39'9" x 55'1"	2,121 ft ²	14'4"	160	108	48	42	200	180
12	SHERATON HALL D	102'6" x 42'1"	2,533 ft ²	14'4"	-	-	-	-	-	-
13	SHERATON HALL E *	83'6" x 73'9"	5,887 ft ²	14'4"	624	300	72	66	650	480
14	SHERATON HALL F	26'7" x 71'9"	1,291 ft ²	14'4"	-	-	-	-	-	-
9-14	SHERATON HALL *	120'10" x 153'5"	18,435 ft ²	14'4"	-	Booths (8'x10'): 76	-	Note: Pillars	1250	950
15	OSGOODE FOYER	26'9" x 46'8"	1,258 ft ²	7'0"	-	-	-	-	-	-
	OSGOODE Foyer Upper	24'1" x 35'	843 ft ²	-	-	-	-	-	-	-
	OSGOODE Foyer Lower	24' x 40'6"	961 ft ²	-	-	-	-	-	-	-
16	OSGOODE BALLROOM WEST *	66'11" x 54'11"	3,579 ft ²	14'4"	462	270	72	54	440	270
17	OSGOODE BALLROOM EAST	102'5" x 54'11"	5,477 ft ²	14'4"	528	324	100	82	650	470
16-17	OSGOODE BALLROOM *	169'4" x 54'11"	9,166 ft ²	14'4"	990	594	Booths (8'x10')	Note: Pillars	1000	740

CONCOURSE: ROOM DIMENSIONS AND SEATING CAPACITY

Rm	Name	Dimensions	Area *	Height	Theatre	Class Room	Square	U-Shape	Reception	Banquet
-	VIP ROOM	49'11" x 28'6"	1,429 ft ²	9'0"	70	50	34	30	100	80
-	MEETING PLANNER OFFICE	30' x 31'	930 ft ²	-	50	20	20	15	50	-
-	CONVENTION REGISTRATION / CONCOURSE CHECKROOM	42'7" x 30'2"	1,289 ft ²	10'0"	-	Note: Four Window Registration Potential				-
-	CONCOURSE LEVEL	79'0" x 86'0"	6,022 ft ²	9'10"	-	-	-	-	-	-

* Area refers to useable function space and not exact square footage. Some obstructions may exist. * Please ask for a detailed plan for location of pillars in these rooms.

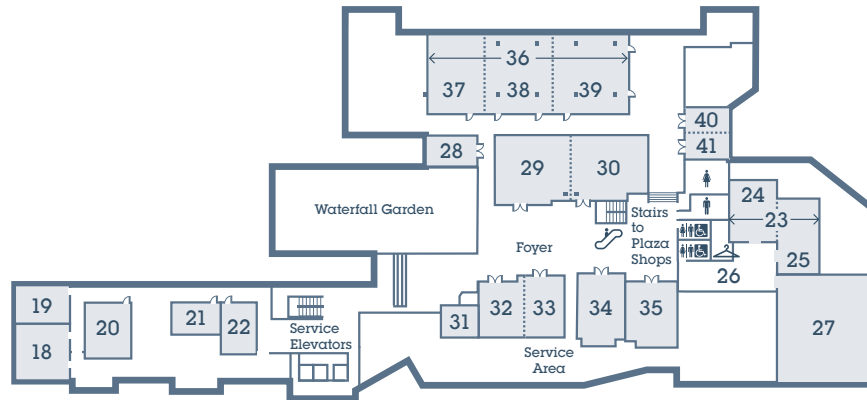

MEZZANINE: ROOM DIMENSIONS AND SEATING CAPACITY

Rm	Name	Dimensions	Area *	Height	Theatre	Class Room	Square	U-Shape	Reception	Banquet
18	YORK	28'9" x 25"	720 ft ²	8'3"	68	44	30	26	70	50
19	PEEL	18'7" x 26'5"	489 ft ²	8'4"	40	24	28	19	50	30
20	NORFOLK	27'7" x 24'3"	669 ft ²	8'3"	40	21	18	12	35	20
21	OXFORD	23'6" x 16'1"	368 ft ²	8'3"	35	18	18	15	35	20
22	CARLETON	17'10" x 25'5"	477 ft ²	8'4"	40	21	18	12	35	20
23	PINE	39'2" x 47'1"	1,664 ft ²	8'	135	80	52	44	150	120
24	PINE WEST	31'11" x 25'6"	824 ft ²	8'	80	25	32	24	80	60
25	PINE EAST	39'3" x 21'6"	833 ft ²	8'	80	40	32	28	80	60
26	BIRCHWOOD FOYER	56'11" x 25'7"	1,050 ft ²	8'10"	-	-	-	-	110	-
27	BIRCHWOOD BALLROOM	61'2" x 45'4"	2,841 ft ²	9'5"	220	150	80	60	220	220
28	OAK	25'0" x 16'4"	422 ft ²	8'10"	-	-	Permanent Boardroom Set Up for 10			-
29	CHESTNUT WEST *	43'2" x 29'11"	1,126 ft ²	9'11"	90	55	34	25	90	90
30	CHESTNUT EAST *	38'8" x 29'11"	1,093 ft ²	9'11"	80	55	30	25	85	80
29-30	CHESTNUT WEST & EAST *	81'8" x 29'11"	2,444 ft ²	9'11"	170	112	60	45	175	170
31	EXECUTIVE MEETING SPECIALIST OFFICE	-	-	-	-	-	-	-	-	-
32	MAPLE WEST *	28'9" x 26'6"	739 ft ²	10'6"	50	40	24	15	55	50
33	MAPLE EAST *	32'2" x 21'8"	654 ft ²	10'6"	55	34	16	10	55	40
32-33	MAPLE WEST & EAST *	48'2" x 28'9"	1,393 ft ²	10'6"	80	60	34	30	110	110
34	LINDEN	37'7" x 26'5"	950 ft ²	9'2"	70	45	34	30	75	70
35	CEDAR	34'8" x 28'3"	939 ft ²	9'1"	75	45	34	30	75	70
	MEZZANINE FOYER	103'11" x 42"	3,488 ft ²	8'10"	-	-	-	-	420	-
36	WILLOW	118' x 41'	4,858 ft ²	9'	260	210	70	60	-	280
37	WILLOW WEST	25' x 41'	1,025 ft ²	9'	65	40	30	28	-	80
38	WILLOW CENTRE	54' x 41'	2,214 ft ²	9'	120	100	46	40	-	120
39	WILLOW EAST	39' x 41'	1,599 ft ²	9'	85	28	32	32	-	80
40	SPRUCE NORTH	12'5" x 24'5"	305 ft ²	8'25"	15	-	12	-	-	-
41	SPRUCE SOUTH	14' x 24'5"	366 ft ²	9'	15	-	12	-	-	-
40-41	SPRUCE	22'5" x 24'5"	624 ft ²	9'	30	18	18	15	26	24

* Area refers to useable function space and not exact square footage. Some obstructions may exist. * Please ask for a detailed plan for location of pillars in these rooms.



SECOND FLOOR: ROOM DIMENSIONS AND SEATING CAPACITY

Rm	Name	Dimensions	Area *	Height	Theatre	Class Room	Square	U-Shape	Reception	Banquet
42	DOMINION BALLROOM N.	58' x 48'6"	2,871 ft ²	11'11"	250	175	70	60	450	240
43	DOMINION BALLROOM S.	51'10" x 48'7"	2,517 ft ²	11'11"	200	150	70	56	400	220
42-43	DOMINION BALLROOM	48'5" x 111'	5,390 ft ²	11'11"	650	378	110	-	850	450
	DOMINION FOYER	131'3" x 24'2"	2,997 ft ²	11'8"	-	-	-	-	-	-
44	ROOSEVELT	26'4" x 17'	432 ft ²	11'2"	40	21	18	12	35	20
45	MACKENZIE	26'5" x 17'	432 ft ²	11'2"	40	21	18	12	35	20
46	CHURCHILL	53' x 17.8'	915 ft ²	11'2"	80	50	32	24	80	60
	CHURCHILL FOYER	97'5" x 13'5"	1,276 ft ²	11'2"	-	-	-	-	-	-
47	CITY HALL *	43' x 55'9"	2,366 ft ²	11'6"	135	80	52	44	150	120
	CITY HALL FOYER	32'3" x 35'1"	1,120 ft ²	-	-	-	-	-	-	-
	New dimensions									
48	PROVINCIAL BALLROOM N.	69.2' x 43'9"	3,037 ft ²	10.9'	160	144	40	35	300	260
49	PROVINCIAL BALLROOM S.	60' x 35"	2,090 ft ²	10.9'	72	63	32	28	175	90
48-49	PROVINCIAL BALLROOM	104' x 52'0"	5,408 ft ²	10.9'	190	126	-	Note: Pillars	475	260
50	ELGIN	21'2" x 31'2"	642 ft ²	11'11"	51	30	30	28	50	40
51	WENTWORTH	24'7" x 31'2"	792 ft ²	11'11"	59	40	34	30	60	50
52	KENORA	24'6" x 31'2"	799 ft ²	11'11"	59	40	34	30	60	50
53	HURON	26'7" x 31'2"	798 ft ²	11'11"	59	40	34	30	60	50
54	KENT	26'8" x 31'2"	801 ft ²	11'11"	59	40	34	30	60	50
55	SIMCOE	26'9" x 31'2"	811 ft ²	11'11"	59	40	34	30	60	50
56	DUFFERIN	26'7" x 31'2"	802 ft ²	11'11"	59	40	34	30	60	50
55-56	SIMCOE & DUFFERIN	51'4" x 31'2"	1,502 ft ²	11'11"	118	70	44	40	110	100
57	CIVIC FOYER	25'6" x 68'	1,707 ft ²	10'11"	-	-	-	-	-	-
58	CIVIC BALLROOM N.	38'5" x 46'7"	1,722 ft ²	11'8"	150	90	58	42	180	160
59	CIVIC BALLROOM S.	58'11" x 46'7"	2,693 ft ²	11'8"	276	153	78	62	260	260
58-59	CIVIC BALLROOM	97'4" x 46'7"	4,400 ft ²	11'8"	450	254	96	88	440	400
60	WATERFALL GARDEN	237'9" x 82'7"	8,560 ft ²	-	-	-	-	-	350	250
	Available for private functions weather permitting.									

* Area refers to useable function space and not exact square footage. Some obstructions may exist. *Please ask for a detailed plan for location of pillars in these rooms.

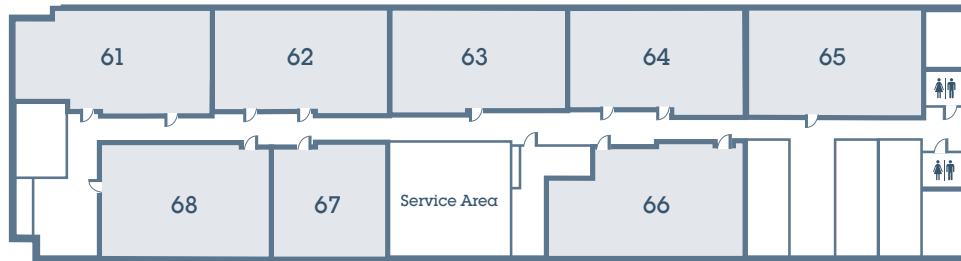

FOURTH FLOOR: ROOM DIMENSIONS AND SEATING CAPACITY

Rm	Name	Dimensions	Area *	Height	Theatre	Class Room	Square	U-Shape	Reception	Banquet
61	LEASIDE	15'10" x 44'3"	689 ft ²	9'11"	46	30	28	25	50	30
62	ROSEDALE	15'9" x 40'	648 ft ²	9'11"	42	30	25	22	50	30
63	FOREST HILL	15'9" x 40'1"	637 ft ²	9'10"	42	30	28	25	50	30
64	KENSINGTON	15'8" x 40'1"	633 ft ²	9'11"	42	30	22	20	50	30
65	DANFORTH	15'8" x 39'11"	617 ft ²	9'10"	42	30	25	22	50	30
66	DAVENPORT	25'3" x 41'1"	1037 ft ²	9'10"	48	36	32	28	70	50
67	YORKVILLE EAST	25'6" x 24'1"	485 ft ²	9'11"	24	18	15	12	40	20
68	YORKVILLE WEST	17'8" x 38'5"	734 ft ²	9'10"	56	36	30	28	60	50

FORTY-THIRD FLOOR: ROOM DIMENSIONS AND SEATING CAPACITY

Rm	Name	Dimensions	Area *	Height	Theatre	Class Room	Square	U-Shape	Reception	Banquet
-	CLUB BOARDROOM	27'2" x 12'8"	348 ft ²	7'10"	-	-	Permanent Boardroom Set Up for 14			-
-	PINNACLE ROOM	42' x 11'	462 ft ²	7'10"	70	50	40	24	70	50
-	PINNACLE FOYER	38'1" x 11'1"	418 ft ²	-	-	-	-	-	-	-

* Area refers to useable function space and not exact square footage. Some obstructions may exist. * Please ask for a detailed plan for location of pillars in these rooms.



Sheraton

CENTRE TORONTO HOTEL

Meeting Facilities

- M Carleton
- 2 Churchill Foyer
- 2 Churchill
- 2 City Hall
- 2 Civic Ballroom
- 2 Civic Foyer
- M Maple West
- M Maple East
- M Linden
- M Cedar
- 4 Davenport
- 2 Dominion Ballroom
- 2 Dominion Foyer
- 2 Dufferin
- 2 Elgin
- M Birchwood Ballroom
- M Birchwood Foyer
- 4 Forest Hill
- LC Grand Ballroom
- LC Grand Ballroom Foyer
- 2 Huron
- 2 Kenora
- 4 Kensington
- 2 Kent
- 4 Leaside
- 2 Mackenzie
- M Norfolk
- L Office
- LC Osgoode Ballroom
- LC Osgoode Foyer
- M Oxford
- M Peel
- 2 Provincial Ballroom
- 2 Roosevelt
- 4 Rosedale
- LC Sheraton Hall A-F
- 2 Simcoe
- M Spruce North
- M Spruce South
- 4 Yorkville East
- 4 Yorkville West
- C Vide
- C VIP Room
- 2&M Waterfall Garden
- 2 Wentworth
- M Willow East
- M Willow Centre
- M Willow West
- M Pine East
- M Pine West
- M York

Hotel Services

- L Arrival Court
- C ATM
- L Baggage Room
- L Bell Desk
- L FedEx Business Centre
- C Convention Registration
- C Currency Exchange
- C Food Court
- L Front Desk
- L Quinn's Steakhouse
- L Link @ Sheraton
- L Lobby Cafe
- C Parking (City Hall Underground Lot)
- C PATH Underground Network
- C PSAV Audio Visual Services
- LC Receiving/Loading Dock
- C Security
- L&C Sheraton Shops
- L SPG/Club Reception
- L BnB (Breakfast 'n' Bistro)
- L Concierge / Tour Desk
- L Valet Parking
- LC Vide Office
- C VIP Room
- 2&M Waterfall Garden

Service Symbols

- \$ ATM
- ☑ Coatcheck
- 🍽 Food Court
- 🅇 Parking (City Hall Lot)
- 🍴 Restaurants
- 🚿 Washrooms
- ♿ Wheelchair Accessible Elevator

4TH FLOOR

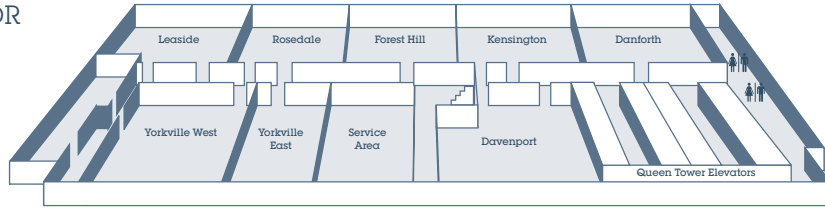

2ND FLOOR

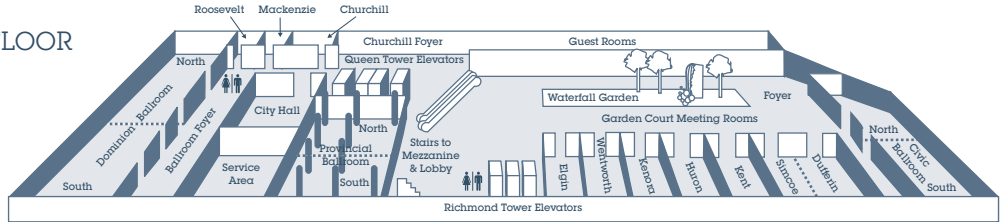

MEZZANINE

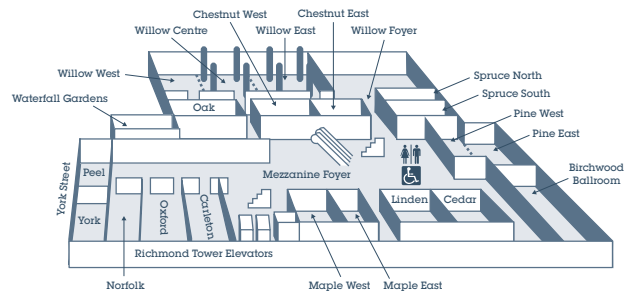
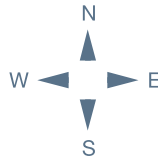

LOBBY

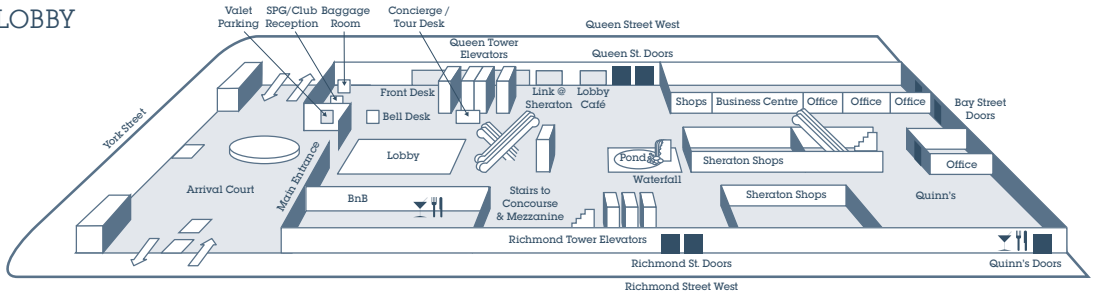

CONCOURSE

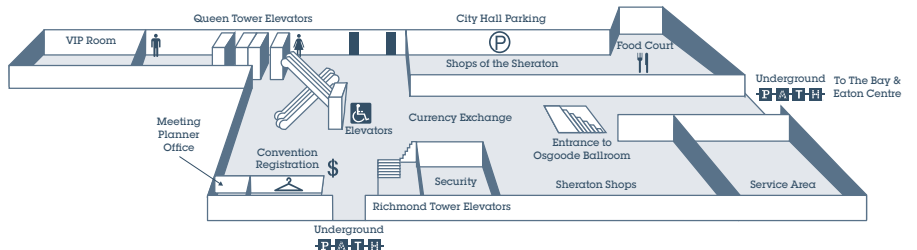

LOWER CONCOURSE

